

# INSIDE/OUTSIDE DOUBLE SHEATHED DROP CABLE 1FO SC/APC G.657B3

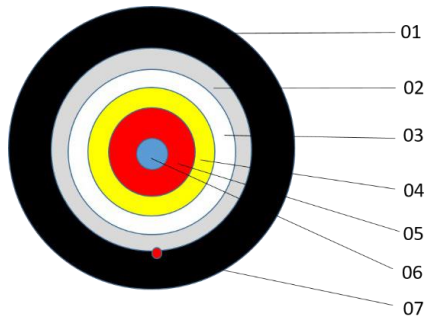

The Telenco® double sheathed drop cable is a solution enabling simple, fast and reliable outdoor-indoor transitions. Thanks to its Low Smoke Zero Halogen Flame Retardant inner cable, it can be used for indoor applications.

The cable enables the transmission of optical signals from an outdoor distribution point to a telecommunications outlet without weighing down the optical budget.

LEGEND	
1	Outer jacket
2	Water blocking tape
3	Inner jacket
4	Aramid yarn
5	Buffer
6	Optical fibre
7	Rip cord

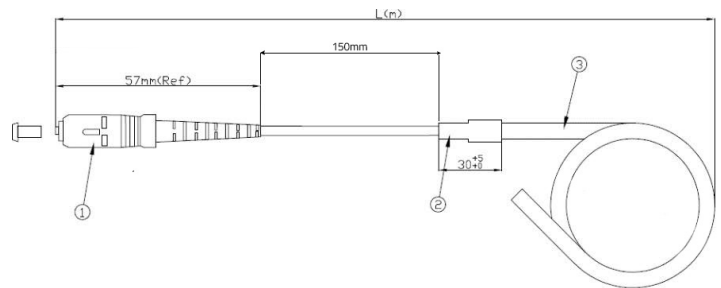

Connector assembly scheme

## CABLE SPECIFICATION

Fibre type	G657.B3	
Fibre cores	1FO	
Outer jacket	OD (mm)	5.0mm
	Material	UV-LSZH
	Colour	Black
Inner cable	OD (mm)	3.0mm
	Material	FR-LSZH
	Colour	White
Buffer	OD (mm)	0.9mm
	Material	LSZH
Nominal weight (kg/km)	21	
Strength member	Aramid yarn	
Sheath removal	Rip cord	
CPR	Inner cable B2Ca	

## FEATURES & BENEFITS

Enables simple, fast and reliable outdoor – indoor transactions

Compliant with CPR B2Ca inner cable, enables indoor application

Easy to remove outer jacket

## MECHANICAL AND ENVIRONMENTAL PERFORMANCE

PARAMETRES	Method	VALUES
Tensile performance	IEC 60794-1-21 – Method E1	100N (Long term) / 200N (Short term)
Crush	IEC 60794-1-21 - Method E3	300N (Long term) / 1000N (Short term)
Impact	IEC 60794-1-21 - Method E4	Impact energy : 1Nm
Outer cable bend	IEC 60794-1-21 - Method E11A	12 x fibre cable diameter, 5 turns per helix, 3 cycles
Inner cable band	IEC 60794-1-21 - Method E11A	10mm 5 turns per helix, 3 cycles
Torsion	IEC 60794-1-21 - Method E27	20N ± 180°, 10 cycles
Temperature cycling	IEC 60794-1-22 - Method F1	-10°C ~ 60°C
Abrasion	IEC 60794-1-21 - Method E2B	5N, 5 times
Frame retardant (Inner cable)		CPR B2Ca

## OPTICAL PERFORMANCE

PARAMETRES	VALUES
Fibre type	G657B3
Attenuation (dB/km)	0.35 (1310nm)/0.21 (1550nm)
Zero dispersion slope	≤0.092 ps/(km*nm <sup>2</sup> )
Dispersion (1285~1340nm)	-3.5~3.5 ps/(km*nm)
Mode field diameter @1310nm	8.4~9.2μm
Cut-off wavelength cable (nm)	≤1260
Min bend diameter (mm)	5
Cladding diameter (μm)	125.0±0.7
Coating diameter (μm)	240±5

## CONNECTOR PERFORMANCE

PARAMETRES	VALUES
Connector type	SC/APC
IL	1310nm/1550nm≤0.30dB
RL	≥60dB
Storage Temperature:	-40°C~+70°C
Work Temperature	20°C~+60°C